

THIS DRAWING IS THE PROPERTY OF T&M CONSULTANTS ONE DESIGN SOLUTIONS AND IS MERELY LOANED FOR LIMITED USE SUBJECT TO THE CONDITION THAT IT SHALL NOT BE REPRODUCED LOANED OR USED IN ANY WAY DEPREMIAL TO OUR INTEREST

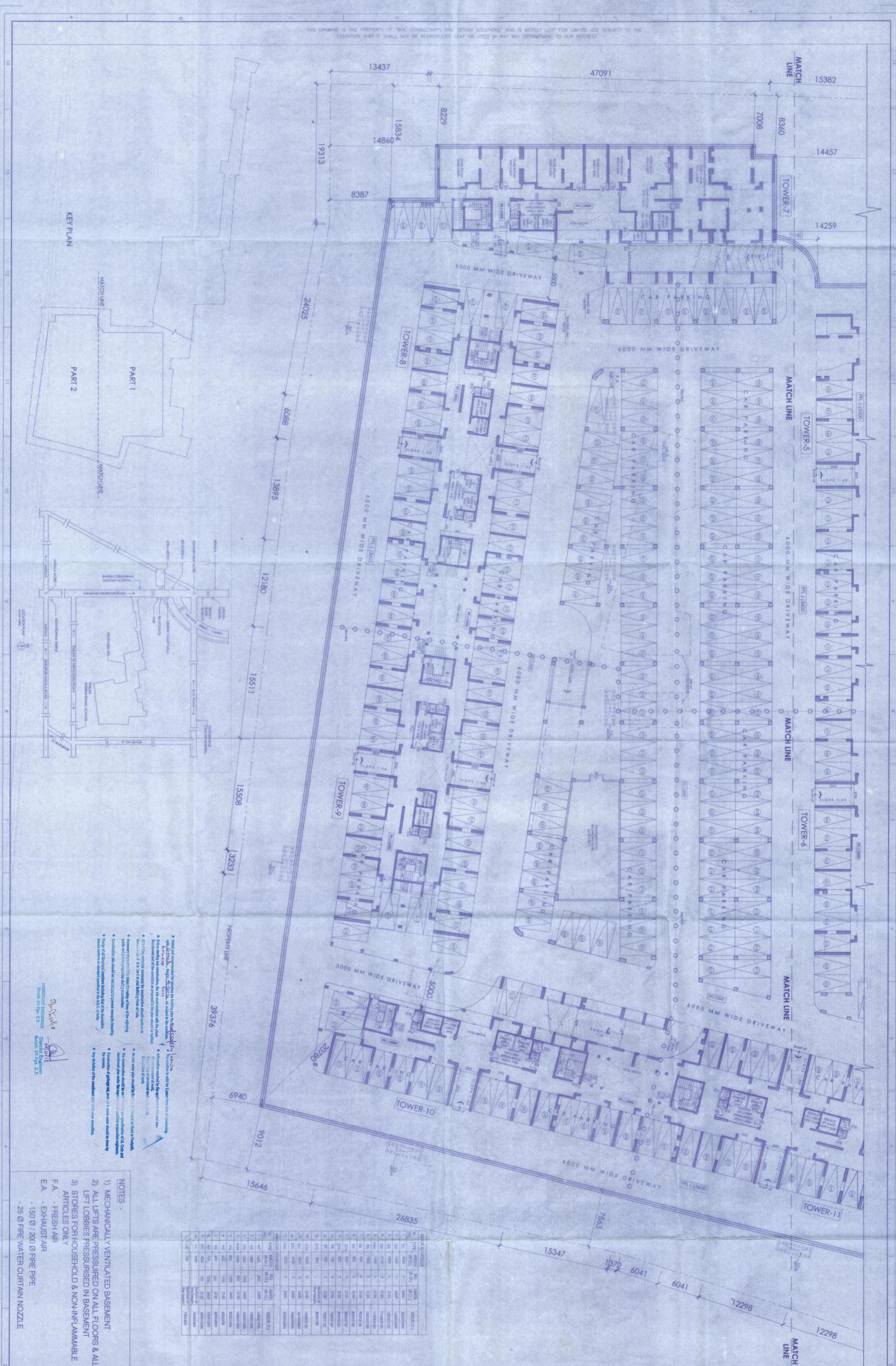

KEY PLAN

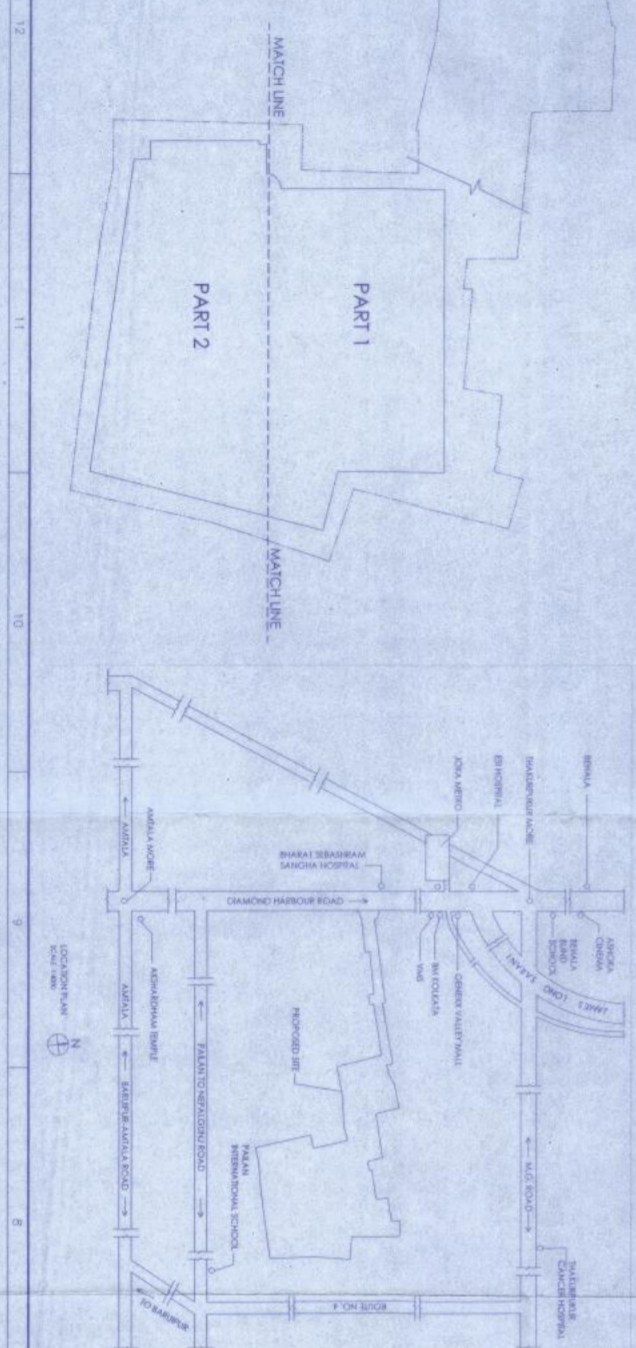

- 1) MECHANICALLY VENTILATED BASEMENT
- 2) ALL LIFTS ARE PRESSURED ON ALL FLOORS & ALL LIFT LOBBIES PRESSURED IN BASEMENT
- 3) STORES FOR HOUSEHOLD & NON-INFLAMMABLE ARTICLES ONLY
- FA - FRESH AIR
- EA - EXHAUST AIR
- 150 Ø / 200 Ø FIRE PIPE
- 25 Ø FIRE WATER CURTAIN NOZZLE

NOTES:

NO.	DESCRIPTION	UNIT	QTY	AMOUNT	TOTAL
1
2
3
4
5
6
7
8
9
10
11
12
13
14
15
16
17
18
19
20
21
22
23
24
25
26
27
28
29
30
31
32
33
34
35
36
37
38
39
40
41
42
43
44
45
46
47
48
49
50
51
52
53
54
55
56
57
58
59
60
61
62
63
64
65
66
67
68
69
70
71
72
73
74
75
76
77
78
79
80
81
82
83
84
85
86
87
88
89
90
91
92
93
94
95
96
97
98
99
100

MADE OF COURSE:

PS/PAW/VA/COM/EX/LUP

GENERAL NOTES:

1. ALL DIMENSIONS ARE IN METERS UNLESS OTHERWISE SPECIFIED.
2. ALL WORK IS TO BE ACCORDING TO THE LATEST EDITIONS OF THE SANS STANDARDS.
3. ALL MATERIALS TO BE USED ARE TO BE APPROVED BY THE ENGINEER.
4. ALL WORK IS TO BE COMPLETED WITHIN THE SPECIFIED TIME FRAME.
5. ALL WORK IS TO BE COMPLETED WITHIN THE SPECIFIED BUDGET.
6. ALL WORK IS TO BE COMPLETED WITHIN THE SPECIFIED QUALITY STANDARDS.
7. ALL WORK IS TO BE COMPLETED WITHIN THE SPECIFIED SAFETY STANDARDS.
8. ALL WORK IS TO BE COMPLETED WITHIN THE SPECIFIED ENVIRONMENTAL STANDARDS.
9. ALL WORK IS TO BE COMPLETED WITHIN THE SPECIFIED SOCIAL STANDARDS.
10. ALL WORK IS TO BE COMPLETED WITHIN THE SPECIFIED ECONOMIC STANDARDS.

CONTRACTOR:

MAN CONSULTANTS ONE DESIGN SOLUTIONS

15th Floor, 15th Avenue, Sandton, Johannesburg, South Africa

Phone: +27 (0) 11 791 1111

Website: www.man.co.za

DATE: 2024-02-22

SCALE: 1:100

PROJECT NO.: JKA-SD-02-2

CLIENT: MAN CONSULTANTS ONE DESIGN SOLUTIONS

DESIGNER: MAN CONSULTANTS ONE DESIGN SOLUTIONS

CHECKER: MAN CONSULTANTS ONE DESIGN SOLUTIONS

APPROVER: MAN CONSULTANTS ONE DESIGN SOLUTIONS